

Misting Fan Owner's Manual

Model :
FM-68, FM-68W, FM-88W, FT-68W, FT-88W

(220-240V~, 50Hz)

Read and save these instructions before use



Read and save these instructions
www.xpower.com | www.tx-5.com.hk

Index: EU-1-A36
Edition: 1.0.Final

Safety Instructions

WARNING - READ AND SAVE THIS INSTRUCTIONS BEFORE USING THIS PRODUCT.

The user of electrical products may create hazards that include, but are not limited to injury, fire, electrical shock. Failure to follow these instructions may damage and/or impair its operation and void the warranty.

- Before operating, remove all packaging material and check for any damage that may have occurred during shipping or any missing items.
- Check power supply to ensure it matches the appliance's specification.
- **Do not** operate any fan with a damaged cord or plug. Discard fan or return it to an authorized service facility for examination and/or repair.
- **Do not** run cord under carpeting. **Do not** cover cord with throw rugs, runners, or similar coverings. **Do not** route cord under furniture or appliances. Arrange cord away from traffic area and where it will not be tripped over.
- To reduce the risk of fire or electric shock, **DO NOT** use this fan with any solid-state speed control device.
- This fan is an outdoor product and is **Not** intended for indoor use. **Do not** leave the fan unattended when it is plugged in.
- **Do not** touch this appliance or the plug with wet hands or while standing in water.
- **Do not** operate the appliance in any pooled water.
- **Do not** use the product in areas where gasoline, paint or other flammable goods and objects are used or stored.
- **Do not** insert or allow objects to enter any ventilation or exhaust opening as this may damage the appliance and void the warranty.
- **Do not** cover the air inlet or outlet on the appliance.
- **Do not** direct the air flow at human faces or bodies.
- **Do not** allow children to play or with this appliance.
- **Do not** move or carry this appliance while the unit is operating.
- Always place this appliance on a smooth and level surface for safe operation.
- **Automatically Operated Device** – To reduce the risk of injury, disconnect from power supply before servicing.
- Remove the power cord from the electrical receptacle by grasping and pulling on the power cord plug-end only, **do not** pull the cord directly.
- **Do not** attempt to repair or adjust any electrical or mechanical functions of this appliance, as this may cause danger and void the warranty.
- This product employs overload protection (fuse). A blown fuse indicates an overload or short-circuit situation. If the fuse blows, unplug the product from the outlet. Replace the fuse as per the user servicing instructions (follow product marking for proper fuse rating) and check the product. If the replacement fuse blows, a short-circuit may be present and the product should be discarded or returned to an authorized service facility for examination and /or repair.
- If the appliance is damaged or it malfunctions, **DO NOT** continue to use it. Unplug the product from the electrical outlet. Refer to troubleshooting guide or contact XPOWER.
- Store in a dry area, away from exposure to sunlight, extreme temperature and humidity, or other extreme environments, when not in use.
- An electronic instruction manual can be obtained through website www.xpower.com.

Grounding Instructions

This appliance must be grounded. In the event of malfunction or breakdown, grounding provides a path of least resistance for electric current to reduce the risk of electric shock. This appliance is equipped with a cord having an equipment-grounding conductor and a grounding plug. The plug must be plugged into an appropriate outlet that is properly installed and grounded in accordance with all local codes and ordinances.

A qualified electrician should be consulted if there is any doubt as to whether an outlet box is properly grounded.

DANGER: Improper connection of the equipment-grounding conductor can result in a risk of electric shock. The conductor with insulation having an outer surface that is green with or without yellow stripes is the equipment-grounding conductor. When repair or replacement of the cord or plug is required, do not connect the grounding wire to either flat blade pin. Check with a qualified electrician or serviceman if the grounding instructions are not completely understood, or if in doubt as to whether the appliance is properly grounded. Do not modify the plug provided with the appliance – if it will not fit the outlet, have a proper outlet installed by a qualified electrician.

Parts Description

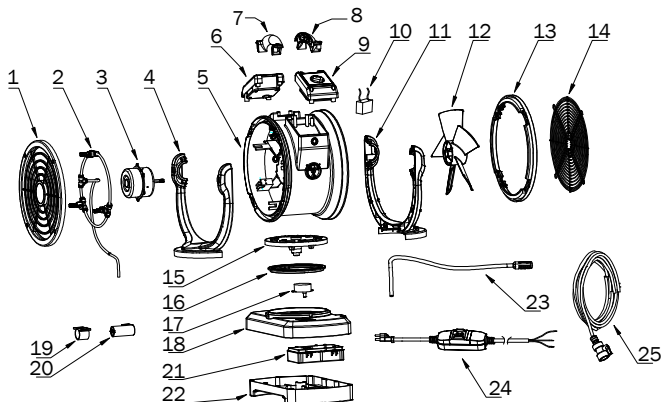

- | | | |
|---------------------------------------|------------------------|---|
| (1) Front Grille Cover | Assembly | (19) Water Pump Shockproof Pad* |
| (2) Atomization Assembly | (10) Capacitor | (20) Water Pump* |
| (3) Motor | (11) Rear Rack | (21) Water Pump Circuit Board Assembly* |
| (4) Front Rack | (12) Fan | (22) Bottom Base Cover |
| (5) Housing | (13) Rear End Cover | (23) Pumping Hose* |
| (6) Oscillation Switch Panel Assembly | (14) Rear Grille Cover | (24) Power Cord |
| (7) Housing Handle Front | (15) Rack Base | (25) Water Hose** |
| (8) Housing Handle Rear | (16) Plastic Washer | |
| (9) Speed Switch Panel | (17) Oscillation Motor | |
| | (18) Top Base Cover | |

* For model FM-68W, FM-88W, FT-68W, FT-88W only.

** For model FM-68 only.

Items Included

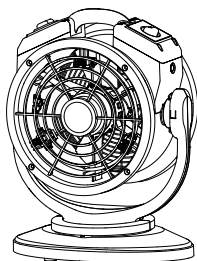

- Misting Fan x 1



- Spare Misting Nozzle x 1



- Nozzle Cleaner x 1



- Owner's Manual x 1

Installation and Operation Guide

Water Source Connection

For Model FM-68:

- Screw the water faucet adapter onto the water faucet.
- Turn the switch to desired position to open or close the valve.
- Turn on the water faucet.

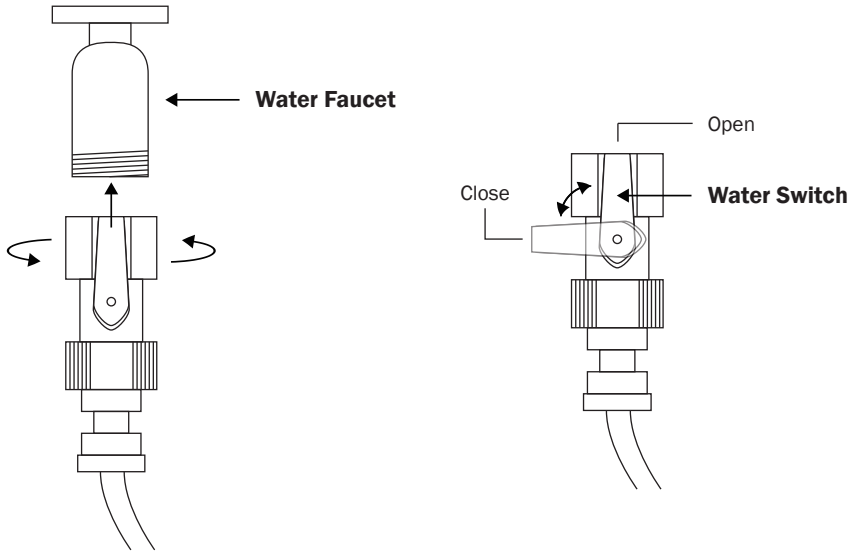

For Model FM-68W, FM-88W, FT-68W and FT-88W:

- The misting fan must connect to a container with water as a source of water.
- You can choose your own container or use XPOWER Water Tank for fast and convenient connection.

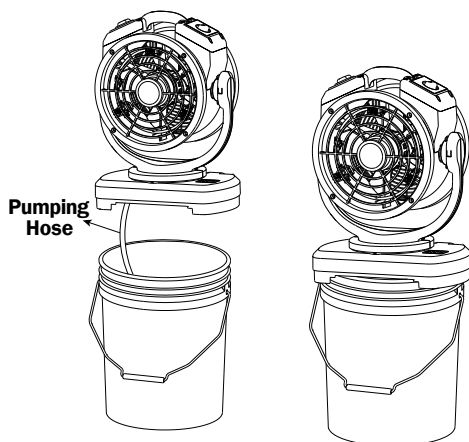

Connect to WT-20

- Put the end of the pumping hose into the WT-20.
- Put the unit onto the WT-20.
- You can also use other alternative bucket with an upper diameter less than 30cm.

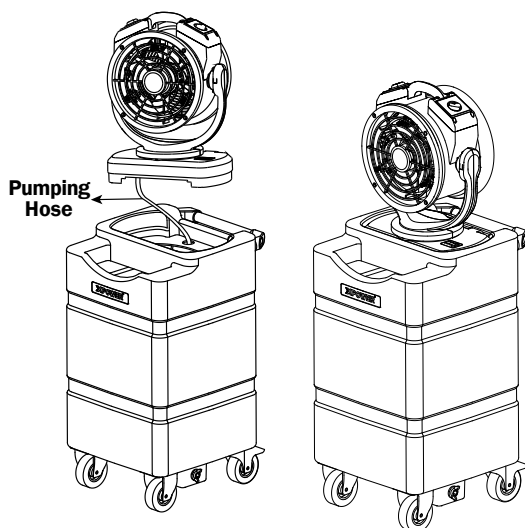

Connect to WT Series

- Put the end of the pumping hose through a small hole into the WT Series.
- Put the into the slot of the WT Series.

If you want to fill the container with a solution / liquid other than water:

- **IMPORTANT:** Always disconnect the machine from the power source before filling the solution.
- Do not exceed the maximum capacity of the container. For WT Series, it's suggested to fill 80% of the maximum capacity.
- **WARNING:** Filling these types of solution / liquid into the solution tank may cause safety hazards, corrosive damages to the machine or blockage of the atomization assembly:
 - (1) Strong acids, strong bases or other corrosive liquids
 - (2) Alcohol, or flammable or explosive liquids
 - (3) Oil, or other organic oils
 - (4) Liquids containing particles or sediments
 - (5) Detergents
- **IMPORTANT:** If you intend to fill the solution of the types mentioned above, please contact the manufacturer of the solution for usage reference and proper methods of cleaning.

Use with Timer Outlet (For Model FT-68W and FT-88W)



- Plug the unit into the timer outlet to control the operation of the misting fan.
- Refer to the instructions of the timer outlet.

RCD Protected Power Cord

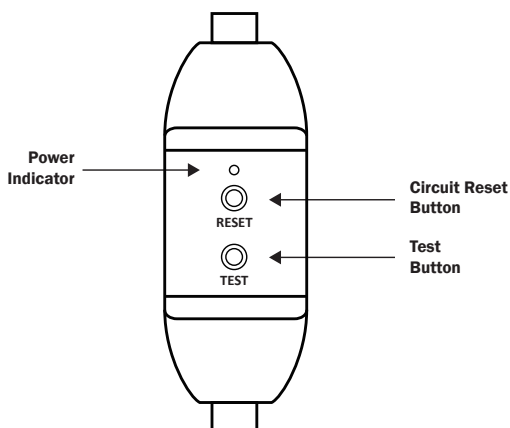

- The power cord of the misting fan is protected by RCD.
- If the misting fan stops working, press the **RESET BUTTON** to reset the circuit.

RCD Protected Power Cord

For RCD (Residual Current Device) protected power cord receptacle:

- Once a ground fault occurs, the RCD will immediately interrupt the power connection to this appliance.
- A ground fault is an inadvertent contact between an energized conductor (for example, a human being) and ground or equipment frame.

WARNING: Risk of electric shock. You should test the RCD before each use.

- Press the Test Button, the Power Indicator should go off. Then press RCD Reset Button, the Power Indicator should illuminate and Test Button should be reset to unpressed position.
- Do not use if the test fails.

Fan Speed Switch

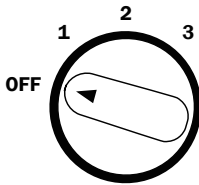

- Turn to “**OFF**” position to switch the misting fan OFF. Turn to any speed position to switch the misting fan ON.
- Turn clockwise to set the desired fan speed. There are 3 fan speeds from: **1, 2, 3**. “**1**” is the lowest speed and “**3**” is the highest speed.

Oscillation Switch

Oscillate



- Switch to “**1**” setting to let the machine oscillate.
- Switch to “**0**” setting to let the machine stay still.

Water Pump Control Panel (For Model FM-68W / FM-88W Only)

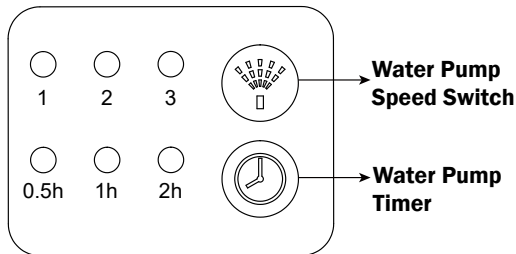

Multiple Operating Positions

Water Pump Speed Switch

- Press to switch the speed of the water pump.
- There are 3 water pump speeds from: **1, 2, 3**. “**1**” is the lowest speed and “**3**” is the highest speed.

Water Pump Timer

- Press to set the timer for an automatic stop of the water pump. The timer controls the water pump only.
- There are three timers from: **0.5 h, 1 h, 2 h** for model FM-68W / **1 h, 2 h, 4 h** for model FM-88W.
- However, if the timer is not set, the water pump will stop working after 4 hour for model FM-68W / 6 hour for model FM-88W.
- When the water pump stops working, press the button to turn on the water pump or set the timer again.

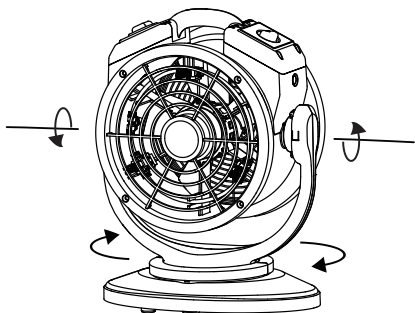

- The misting fan can operate in different positions, directing the airflow and mist to desired areas.

User Maintenance Instructions

Frequent maintenance is recommended on this appliance. Failure to follow the maintenance instructions may cause failure of the appliance and void the warranty.

- When not in use, unplug and store the appliance in a dry and cool indoor place. Make sure it's out of reach of children.
- Before performing any maintenance or cleaning, always disconnect the misting fan from its power source.
- Use a damp cloth to wipe the surface of the housing. Do not clean the unit with water directly.
- Check if the grille covers are clean. Remove dirt or any other objects that could block the air inlet and air outlet.

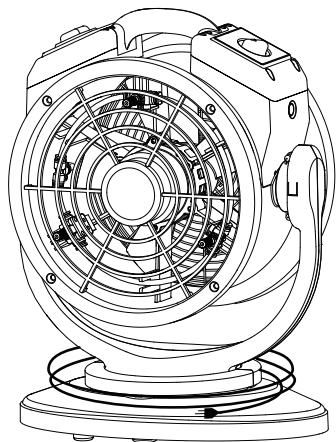

For Model FM-68:

- Wrap the water hose first and then the power cord around the rack base after use.

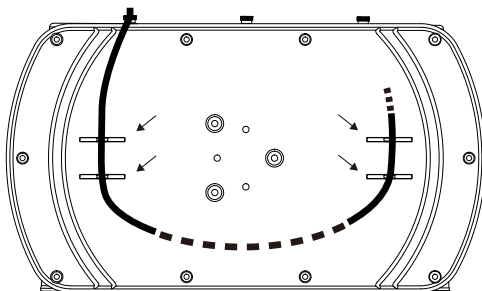
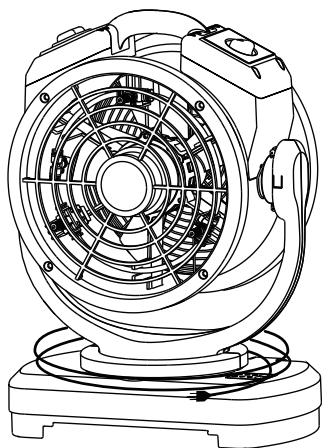

For Model FM-68W/FM-88W/FT-68W/FT-88W:

- Wrap the power cord around the rack base after use.
- Organize the pumping hose onto the bottom of the rack base. Use convenient clip on the housing to secure in place.

Atomization Assembly Maintenance

When not in use, unscrew the misting nozzles, store the nozzles in a dry indoor place out of reach of children. The nozzles must be dried completely before stored.

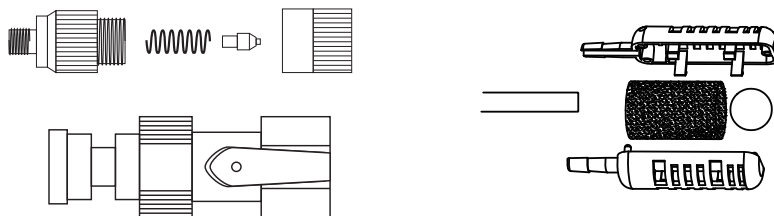

- Disassemble the nozzles (See illustration above) and unscrew the water faucet adapter.
- For model FM-68W, FM-68W, FT-68W or FT-88W, disassemble the pumping hose.
- Soak the parts with soapy water or mild (or alkaline) detergent for several hours.
DO NOT use vinegar or other acidic detergent.

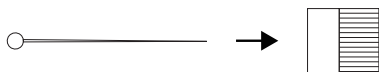

- Optionally, use the nozzle cleaner to clean the nozzle hole from the inner surface.
- When finished, dry the surfaces completely and reassemble the parts.

Troubleshooting Guide

PROBLEM	POSSIBLE CAUSE	SOLUTION
Misting Fan does not start	No electricity.	Check for power supply.
	The power cord is not properly plugged in.	Remove and reconnect the power cord.
	The machine is working under an extreme temperature.	Turn off the machine and unplug it. Let the machine cool down to normal temperature.
	The ground fault protection on the RCD is triggered.	Check and reset the RCD on the plug.
	The anti-toppling safety switch is triggered.	Check and reset the anti-toppling safety switch.
Unit runs but the speed is abnormal	Air inlet or air outlet is blocked.	Remove blockage.
Misting function is abnormal	The pumping / water hose is blocked.	Remove blockage.
	The atomization assembly is blocked.	Remove blockage. (See Page 11: Atomization Assembly Maintenance)
	The water switch is off.	Check for water supply.

If troubleshooting does not resolve your problem, please contact XPOWER or other parties authorized by XPOWER for further instructions.

Technical Specification

MODEL NUMBER	FM-68	FM-68W	FT-68W	FM-88W	FT-88W
Voltage / Frequency	220-240V~, 50Hz				
Power	60 W	68 W		100 W	
Rated Airflow	900 CFM			1450 CFM	
Speed Control	3 Speeds				
Cord Length	3.0 m		7.6 m	3.0 m	7.6 m
Unit Dimension (L) x (W) x (H)	37.5 x 21 x 48.3 cm	37.5 x 21.7 x 51.1 cm		43.5 x 24.5 x 59.8 cm	
Unit Weight	5.8 kg	6.11 kg	6.45 kg	7.73 kg	8.07 kg
Safety Certification	CE/UKCA				

If your product(s) is not listed above, please visit www.xpowermfr.com for more information.

Fogging Outlet Specification

Misting Nozzle		Max Mist Volume	Max Throw Distance
FM-68	0.3 mm (Marked 3010)	5.9 L / h	9.0 m
FM-68W / FT-68W		7.5 L / h	8.0 m
FM-88W / FT-88W		9.5 L / h	10.0 m

XPOWER Limited Warranty

1 YEAR LIMITED WARRANTY

XPOWER-branded products purchased in the U.S. from authorized distributors include a 1-year limited warranty. Contact XPOWER to confirm warranty information about your product(s).

This limited warranty covers defects in materials and workmanship in your XPOWER-branded products. Contact an XPOWER Distributor in your region for warranty service and parts replacement.

Items mentioned but not limited to below are not covered by warranty:

- (1) Power cord, batteries, filters or any other components considered as a “consumable parts” by XPOWER.
- (2) Normal wear and tear.
- (3) Problems that result, directly or indirectly, at XPOWER’s sole discretion, from:
 - (3.1) External causes such as accident, abuse, misuse or problems with electrical power supply.
 - (3.2) Disassembling, servicing or modification not authorized by XPOWER.
 - (3.3) Usage that is not accordant with product instructions stated in Owner’s Manual.
 - (3.4) Failure to follow the product instructions or lack of necessary maintenance stated in Owner’s Manual.



XPOWER Manufacture, INC.

668 S. 6th Ave.,
City of Industry, CA 91746 USA

Read and save these instructions
www.xpower.com | www.tx-5.com.hk

Index: EU-1-A36
Edition: 1.0.Final